

crenova

A4 Laminator
Model: CL01 (Black/White)

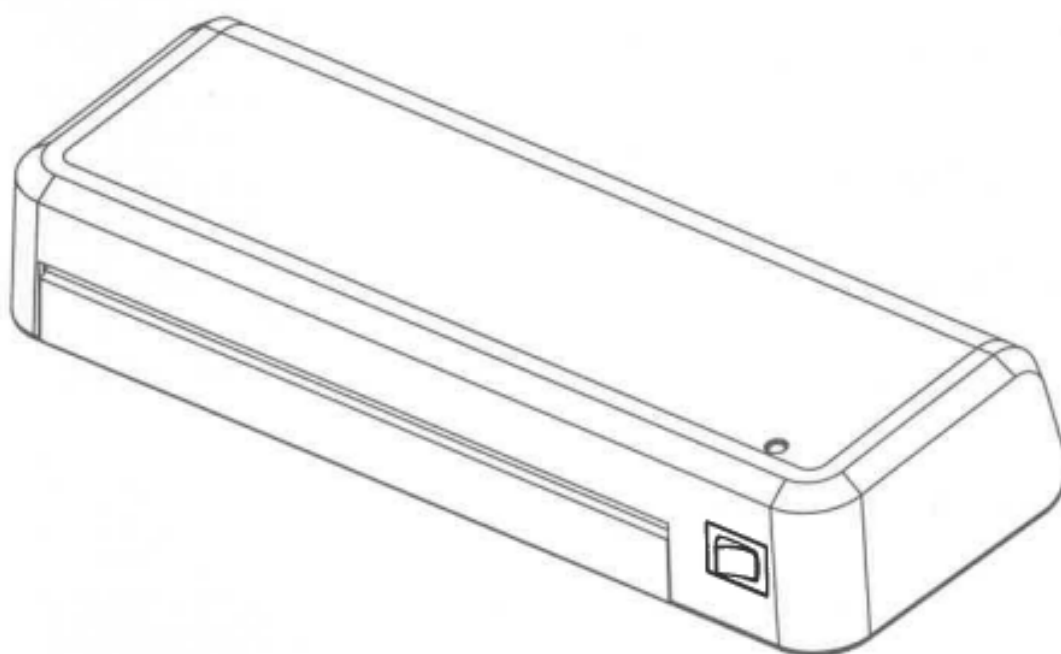

User Manual

Thank you for choosing Crenova Laminator. Please read this manual carefully before your lamination project, and keep it for future use.

* A warranty card is included in the box. Please keep it and email us (support@crenova.net) for further exchange or refund even if the Amazon return window is closed.

* Email us now to activate your warranty, receive a quick start guide video, and discover more delightful surprises!

Contents

| | |
|--|-----------|
| 2-Year Limited Warranty | 1 |
| Contact Us | 2 |
| Helpful Tips & Safety Precautions | 2 |
| WARNING - Electrical Safety | 3 |
| Box Contents | 3 |
| Laminator Parts | 4 |
| Operating Instructions | 4 |
| I. Laminator | |
| II. Paper Cutter | |
| III. Corner Rounder | |
| IV. Hole Punch | |
| Cleaning and Maintenance | 7 |
| Specifications | 7 |
| Troubleshooting | 8 |
| Disposal | 12 |

2-Year Limited Warranty

Your product comes with a 2-year limited warranty from the date of purchase.

| | Amazon | Crenova |
|-----------------------|---|---|
| Return Process | <p>Start a return ▼ Print a label ▼ Prepare a shipping package ▼ Ship it to Amazon ▼ Amazon receives & checks the returned product ▼ Approve your request ▼ Wait for your refund /a new product</p> | <p>Contact us:</p> <ul style="list-style-type: none"> • Email: support@crenova.net (Recommended) • Web: www.crenova.net • Facebook: www.facebook.com/icrenova • Amazon Message |
| Time Spent | 2-3 Weeks | 1 Business day |
| Within 30 Days | Free return & refund policy | Free return & refund policy |
| After 30 Days | × | |
| Exceed 2 Years | × | Provide customer support |

Contact Us

Please feel free to contact us if you meet the following conditions.

| Reason | Exchange or Refund | Contact Us |
|--------------------------------|--------------------|--|
| Defective or Damaged Item | ✓ | <p>Contact us:</p> <ul style="list-style-type: none">• Email: support@crenova.net (Recommended)• Web: www.crenova.net• Facebook: www.facebook.com/icrenova• Amazon Message |
| Damaged During Shipping | ✓ | |
| Damaged After Normal Use | ✓ | |
| Missing or Damaged Parts | ✓ | |
| Not Compatible | ✓ | |
| Not Good as Expected | ✓ | |
| Amazon Return Window Is Closed | ✓ | |
| Other Reasonable Conditions | ✓ | |

Helpful Tips & Safety Precautions

To operate the laminator properly and prevent personal injury or damage to property, read and follow all tips and precautions before use.

1. The laminator is not intended for use by children.
2. Operate the laminator on a flat, stable and secure surface.
3. This machine is only designed for use with thermal laminating pouches/films for laminating paper or paper-like items.

4. Do not touch the inlet, housing, and vent holes when the machine is running.
5. Always use compatible laminating pouches/films (2 x 80-125mic).
6. Do not pull the pouch during lamination process.
7. Do not disassemble the laminator.
8. Do not drop or impact the machine.

⚠ WARNING - Electrical Safety

1. Do not use the different type of power source, it may result in fire or electric shock. Please use the indicated type of power source on the laminator or in the manual.
2. To reduce the risk of electric shock or fire, do not use the machine near water, moisture or heat sources.
3. Do not operate the machine with wet hands.
4. Do not use the laminator with a damaged cord or after the laminator malfunctions or is dropped or damaged in any manner, please contact our customer service for a replacement.
5. Do not pull, twist, or wrap the cord.
6. Turn off the laminator and unplug it while not in use.

Box Contents

| Basic Laminator Set: |
|--|
| 1 x Crenova A4 laminator (Color: White) 30 x Thermal laminating pouches (Size: 5 x A4, 10 x A5, 15 x A6) |
| Deluxe Laminator Set: |
| 1 x Crenova A4 laminator (Color: Black) 1 x Paper cutter 1 x Corner rounder 1 x Hole punch 3 x Binder rings 50 x Thermal laminating pouches (Size: 10 x A4, 15 x A5, 25 x A6) |

Laminator Parts

1. Inlet
2. Ready Indicator
3. On/Off Switch
4. Outlet
5. Jam Release (ABS) Lever

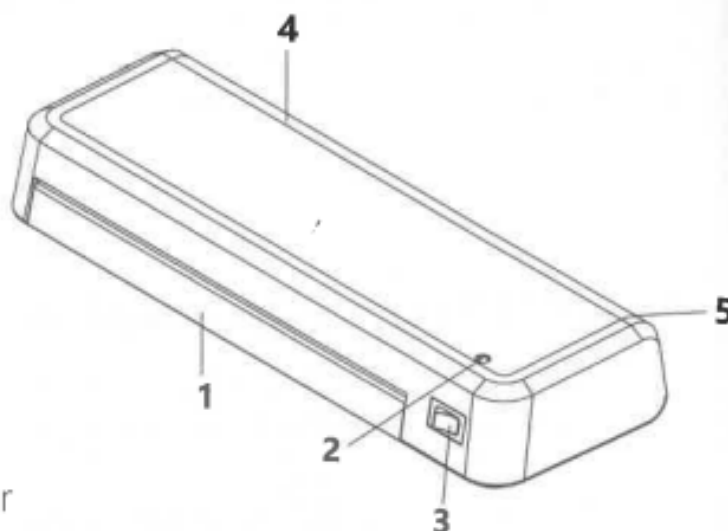

Operating Instructions

I. Laminator

1. Plug the power cord into a standard power outlet.
2. Insert the item to be laminated into a compatible hot laminating pouch (2 x 80-125mic).

Note:

- This machine is only designed for use with thermal laminating pouches/Plms.
- Be sure to leave approx. 3-5mm margins to the edges of the laminating pouch.

3. Move the On/Off Switch to "ON".

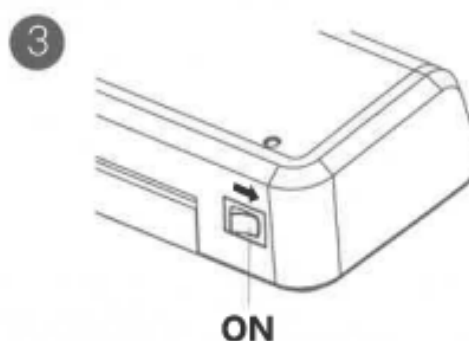
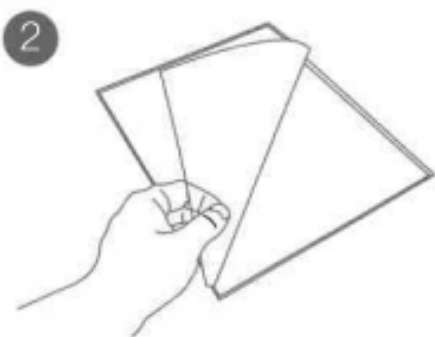

4. After 90 seconds for preheating, the Ready Indicator illuminates green. It means the preheating is completed and the machine is ready for laminating.
5. Insert the pouch with the item into the inlet. The sealed-edge of the pouch should be inserted first.

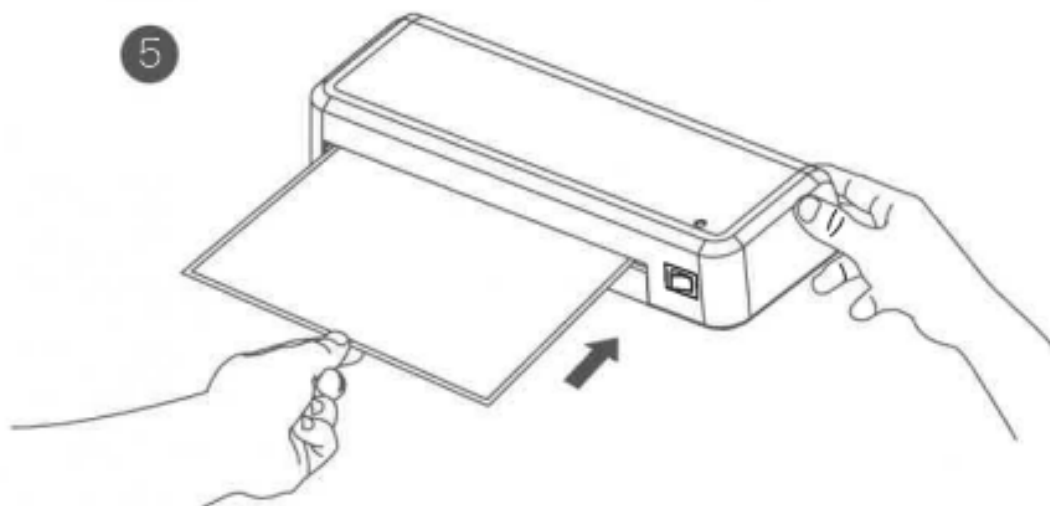

6. The pouch will automatically exit the outlet.

Note:

- The laminating pouch is very hot and soft when exiting the outlet, handle with care.
- You may place a book on the laminated document to flatten and smoothen it.

7. When your laminating task is finished, switch off the laminator and unplug the power cord.

Note:

- Do not touch the inlet, outlet, and housing after laminating, they are hot.
- Allow the machine cool down for a while before clean or store it.

Clearing a Paper Jam

To remove the jammed paper/pouch from the machine:

1. Move the On/Off Switch to "OFF".
2. Press and hold the Jam Release (ABS) Lever.
3. Pull the pouch (with the document) out.
4. Release the Jam Release (ABS) Lever.

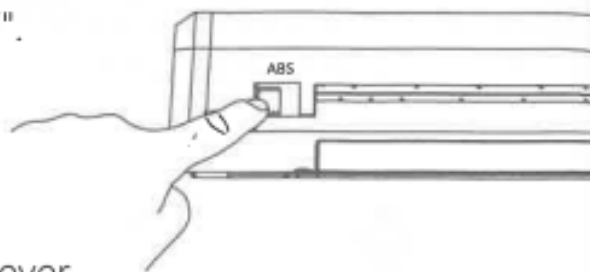

Note:

- It is normal for a laminator to smell when using for the first time. The odor comes from the rubber rollers of the machine.
- To test the machine, please laminate a single sheet of paper without the pouch before your laminating task. The machine works well if it runs a smooth operation. Use the ABS Lever if the paper gets stuck. Contact us for help if the machine or ABS Lever does not work.

II. Paper Cutter

1. Insert the item to be cut.
2. Firmly press the paper cutter, slide it along the slide rail.

Note:

Never touch the edge of the blade.

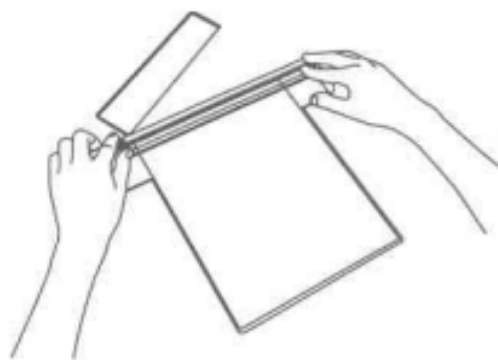

III. Corner Rounder

1. Insert the corner to be trimmed.
2. Press the corner rounder to finish cutting.

Note:

For better performance, the corner should not be inserted too far.

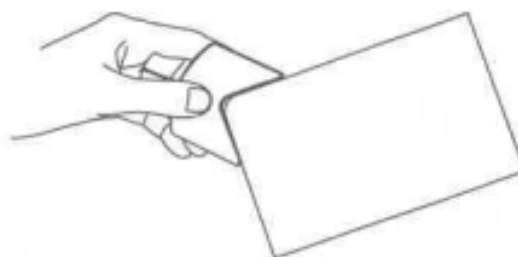

IV. Hole Punch

1. Insert the sheet to be punched into the crevice.
2. Press the punch to cut a hole.
3. Empty paper chad collector regularly.

Note:

Do not touch the crevice of the hole punch.

Cleaning and Maintenance

Let the laminator to cool down and unplug it before cleaning. Use a dry, clean cloth to remove dust. Use a damp cloth with a little mild soap to remove stubborn dirt.

Note: Never use solvents or aggressive cleaning agents.

Store the machine in a cool and dry place.

Specifications



| | |
|----------------------------|--|
| Voltage | AC 220-240V, 50Hz(UK/EU)/ AC 110-120V, 60Hz(US) |
| Power | 220W(UK/EU)/240W(US) |
| Ready Time | 90 Seconds |
| Dimensions | 31.5cm x 10.5cm x 6.1cm/12.4" x 4.1" x 2.4" |
| Maximum Entry Width | 230mm (A4) |
| Maximum Thickness | 0.5mm |
| Pouches Thickness | 2 x 80-125mic |
| Laminating Speed | 250mm/min |

Troubleshooting

To quickly solve your problems and to prevent improper using, please follow operating instructions below. If your problems or enquiries cannot be eliminated after reading the table, please feel free to contact us.

| Problem Description | Reason | Solution |
|---|---|---|
| The Ready Indicator does not light up. | The power cord is not plugged into the power outlet properly. | Make sure the power plug is properly connected. |
| | You move the On/Off Switch to "OFF". | Move the On/Off Switch to "ON". |
| | The Ready Indicator is defective. | Contact us for help (Email: support@crenova.net). |
| The laminating pouch is not completely sealed or is unsealed. | The laminating temperature is too low. | Allow the laminator to fully warm up when using thicker laminating pouches. Laminate the same pouch again to get better lamination result. |
| | The laminating pouch is not compatible. | The Laminator is only designed to use with hot/thermal laminating pouches from 80 to 125 mic |
| Surface of the laminator is too hot. | Room temperature is too high. | The recommended operating temperature should be no more than 28°C. |

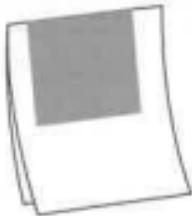
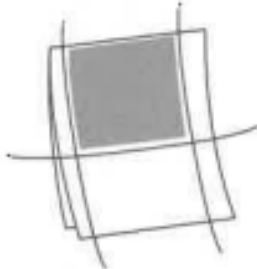
| | | |
|--|--|---|
| Surface of the laminator is too hot. | The preheating time of the machine is too long. | When the green Ready Indicator is on, you should start to laminate immediately. If not, long warm up time will lead to overheating. Note: Always turn off the laminator and unplug it after the job is done. |
| | The machine takes a very long time to preheat, but green Ready Indicator isn't illuminated. | Turn off the machine for 3-5 minutes, then turn on again and start laminating right away. If the laminator works, the Ready Indicator is defective. If not, the roller is defective. Please contact us for a return or a refund (Email: support@crenova.net). |
| The laminating pouch wrinkles or waves.  | Long operating time causes overheating. When laminating temperature is too high, it will affect lamination result. | Turn off the machine for about 3-5 minutes. Allow it to cool down, and then restart. |

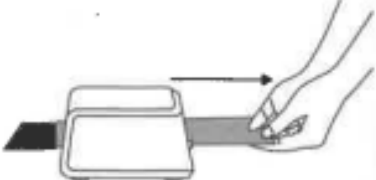
| | | |
|---|--|---|
| <p>The laminating pouch wrinkles or waves.</p>  | <p>The margins to the edges of the laminating pouch are too large.</p>  | <p>Trim/cut the edges of the laminating pouch at first.</p>  |
| <p>The laminating pouch curls up a little.</p>  | <p>Due to the effects of gravity, the pouch will curl up (more or less) when laminating the smaller item.</p>  | <p>Hold the pouch all the way after it exits the outlet.</p>  |
| <p>The pouch gets stuck in the laminating machine.</p> | <p>The item is not loaded straight.</p> | <p>Insert the pouch with the item straight into the inlet.</p> |
| | <p>The laminating pouch is not compatible with the machine.</p> | <p>Please use the pouch from 80 to 125 mic, otherwise it is easy to get jammed</p> |
| | <p>You laminate some specimens, such as pressed plants.</p> | <p>Please kindly note that the laminator is designed to laminate paper or paper-like items only (e.g. card, picture, and schedule).</p> |

| | | |
|--|--|---|
| The device no longer works after a long period of operation or stops during operation. | If the surface of the device is hot, the overheating protection has probably activated and the laminator powers off automatically. | Wait for about 30 minutes and try to laminate again. If the device does not work, feel free to contact us (Email: support@crenova.net) . |
| The machine does not heat up or stops heating up after using it for a few times. | The circuit is defective. | Please contact us for a replacement (Email: support@crenova.net) . |
| The rollers do not run. | Check the power plug connection and the On/Off Switch setting. | Make sure the power plug is properly connected. Be sure to move the On/Off Switch to "ON". If the problem continues, contact us for help. |
| The paper cutter does not work. | High usage frequency makes the cutter get blunt. | Contact us for help (Email: support@crenova.net) . |
| | Wrong operation. | Use the cutter correctly: 1. Insert the sheet under the ruler (slide rail). 2. Press the paper cutter down, slide it along the slide rail. (Remember to press down firmly, because there is a gap between the cutter and the cutting plate.) |